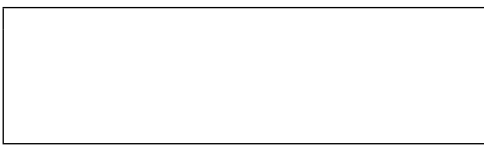

# Inspection protocol forks

Com. No. \_\_\_\_\_  
 Lift truck type \_\_\_\_\_  
 Serial No. \_\_\_\_\_  
 Marking 

## Dimension of fork

■ Width \_\_\_\_\_ mm  
 ■ Thickness \_\_\_\_\_ mm  
 ■ Blade length \_\_\_\_\_ mm  
 ■ Suspension \_\_\_\_\_

### Note

As soon as the marking becomes illegible the fork must be withdrawn from service.

### 1. Wear

Nominal thickness „N“ - 10 %

⇒ **Replace!**

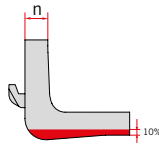

Wear mainly occurs in the outer heel section. Wear area „n“ - 10% = **replace forks!**

Result  OK  
 **NOT OK**  
 Comments \_\_\_\_\_

### 2. Surface cracks

Crack detection

⇒ **Replace!**

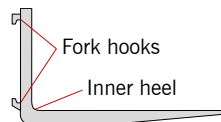

Result  OK  
 **NOT OK**  
 Comments \_\_\_\_\_

### 3. Height difference fork tip

Acceptable: h max. =

Level fork: h =

Replace fork: h more than

$$\frac{L^*}{66} \text{ to } \frac{L^*}{33}$$

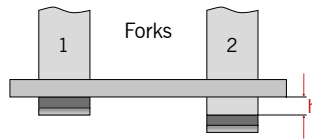

Result  OK  
 **NOT OK**  
 Comments \_\_\_\_\_

### 4. Deflection of blade

Acceptable: k max. =

Level fork: k =

Replace fork: k more than

$$\frac{L^*}{66} \text{ to } \frac{L^*}{33}$$

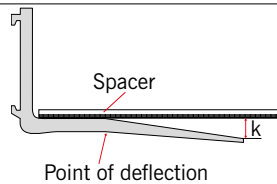

Result  OK  
 **NOT OK**  
 Comments \_\_\_\_\_

### 5. Angularity

Ideal 90°:

d = 707 mm

Acceptable:

d = 695 - 713 mm

Level fork:

d = 714 - 730 mm

Replace fork:

d > 730 mm

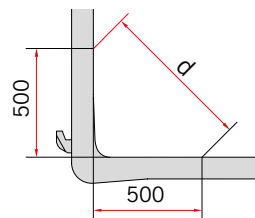

Result  OK  
 **NOT OK**  
 Comments \_\_\_\_\_

**Note:** Sometimes forks are used with deviant angular dimensions for special cases. Please check before inspection!

### 6. Locking devices



Locking device, consisting of:  
 Locking bolt, spring and lever

Result  OK  
 **NOT OK**  
 Comments \_\_\_\_\_

### 7. Damage of tip

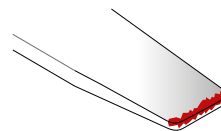

Result  OK  
 **NOT OK**  
 Comments \_\_\_\_\_

### 8. Bending up / wear of hook

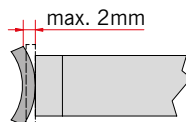

Result  OK  
 **NOT OK**  
 Comments \_\_\_\_\_

## Result

**Important:** Forks should always be replaced in pairs as a damage of one fork implies that also the other fork shows resp. will show corresponding damages.

Forks OK

Forks **NOT OK**

⇒ Scrap! / Replace

⇒ Repair

Name auditor \_\_\_\_\_

Date \_\_\_\_\_

Signature \_\_\_\_\_